

R - IN-60-85

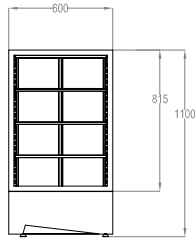

R - IN-60-115 (A)



R - MODELO REFRIGERACIÓN = +4°C/+8°C  
 C - MODELO CALENTADOR = +70°C  
 N - MODELO NEUTRO

IN = MODELO COMPACTO  
 DP = MODELO PARA ENCASTAR  
 (A) - POSIBILIDAD DE AUTOSERVICIO

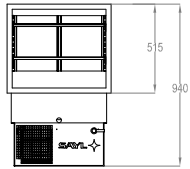

R - DP-60-50G

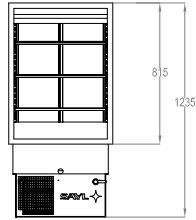

R - DP-60-80G

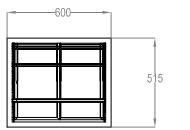

N - IN-60-50N

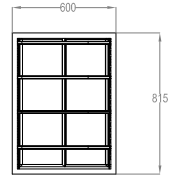

N - IN-60-80N (A)

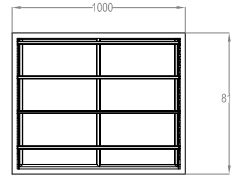

N - IN-100-80N (A)

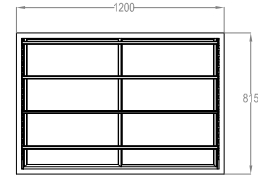

N - IN-120-80N (A)

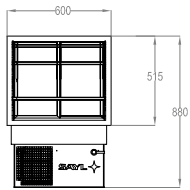

R - DP-60-50

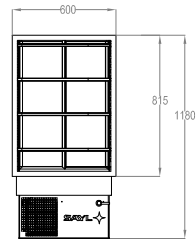

R - DP-60-80 (A)

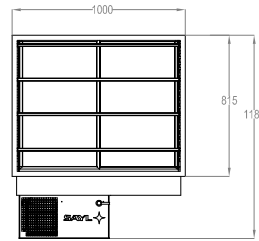

R - DP-100-80 (A)

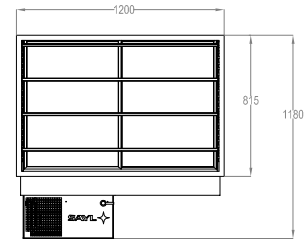

R - DP-120-80 (A)

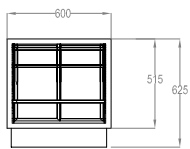

C - DP-60-50C

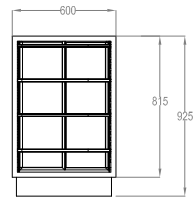

C - DP-60-80C (A)

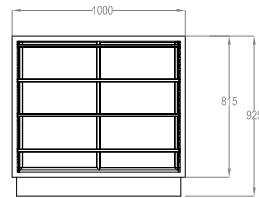

C - DP-100-80C (A)

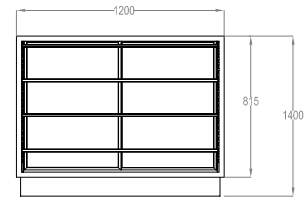

C - DP-120-80C (A)

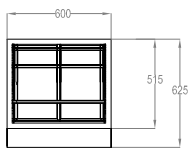

C - IN-60-50C

R - IN60-50R

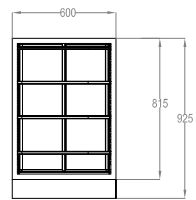

C - IN-60-80C (A)

R - IN-60-80R (A)

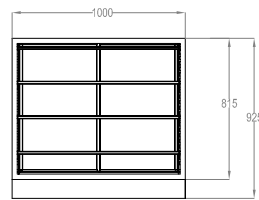

C - IN-100-80C (A)

R - IN-100-80R (A)

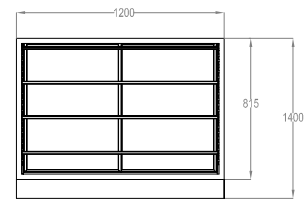

C - IN-120-80C (A)

R - IN-120-80R (A)

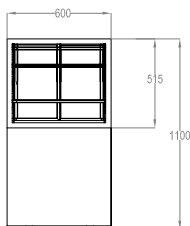

R - IN-60-110  
 C - IN-60-110C  
 N - IN-60-110N

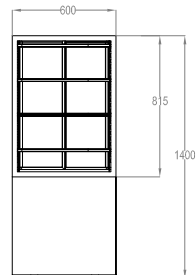

R - IN-60-140 (A)  
 C - IN-60-140C (A)  
 N - IN-60-140N (A)

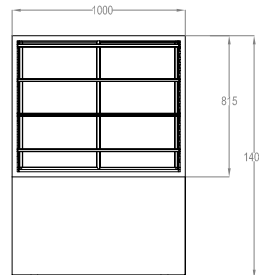

R - IN-100-140 (A)  
 C - IN-100-140C (A)  
 N - IN-100-140N (A)

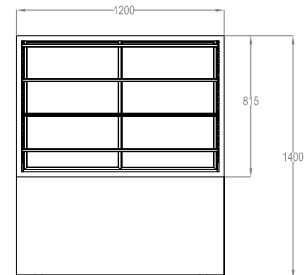

R - IN-120-140 (A)  
 C - IN-120-140C (A)  
 N - IN-120-140N (A)